



TRAP STATION

MODEL V1/V2

FORGED TRAP STATION EQUIPPED WITH BUILT-IN BELLOWS-SEALED VALVES

Benefits

Compact valve and steam trap station for use with condensate manifolds or applications with limited installation space.

1. All wetted components are stainless steel.
2. Rugged, compact and versatile design minimizes installation area and easily adapts to plant requirements.
3. Built-in bellows-sealed valves have durable stainless steel bellows to eliminate gland leakage.
4. Good seal with stellite hardened surfaces on valve plug and valve seat.
5. **QuickTrap** 2-bolt universal connection permits trap unit replacement in minutes without disturbing piping.
6. Built-in screen with large surface area ensures trouble-free operation.
7. Includes built-in BO2 blow-off valves for station blowdown and trap testing.

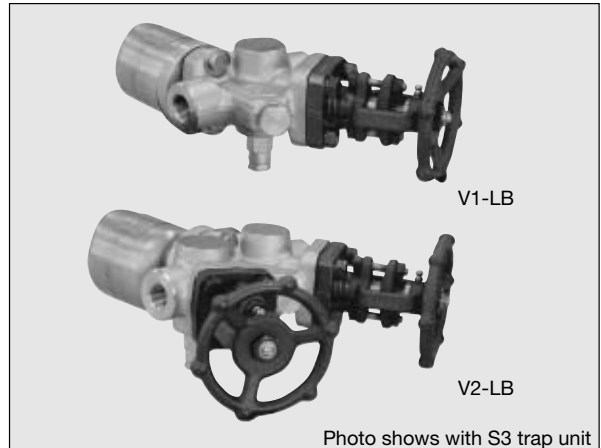

Photo shows with S3 trap unit

CAUTION DO NOT DISASSEMBLE OR REMOVE THIS PRODUCT WHILE IT IS UNDER PRESSURE. Allow internal pressure of this product to equal atmospheric pressure and its surface to cool to room temperature before disassembling or removing. Failure to do so could cause burns or other injury. READ INSTRUCTION MANUAL CAREFULLY.

Specifications

Model	V1-RB		V1-LB		V2-RB		V2-LB	
Connection	Screwed	Socket Weld	Screwed	Socket Weld	Screwed	Socket Weld	Screwed	Socket Weld
Size (in)	1/2, 3/4	1/2, 3/4	1/2, 3/4	1/2, 3/4	1/2, 3/4	1/2, 3/4	1/2, 3/4	1/2, 3/4
Built-in Valve Location	1 valve at trap inlet				1 valve at trap inlet, 1 valve at trap outlet			
Maximum Operating Pressure (psig) PMO					650*			
Maximum Operating Temperature (°F) TMO					752*			
Maximum Allowable Pressure (psig) PMA					650*			
Maximum Allowable Temperature (°F) TMA					752*			

* For trap station only; further restricted by mounted trap unit

Connections and sizes in bold are standard

CAUTION To avoid abnormal operation, accidents or serious injury, DO NOT use this product outside of the specification range. Local regulations may restrict the use of this product to below the conditions quoted.

No.	Description	Material	ASTM/AISI*	JIS
①	Body	Carbon Steel	AISI304	SUS304
② ^R	Valve Bonnet	Carbon Steel	A105	—
③ ^R	Valve Plug	Stainless Steel + Stellite	A276-304	—
④	Valve Seat	Stainless Steel + Stellite	A276-410	—
⑤ ^R	Valve Stem	Stainless Steel	A276-410	—
⑥ ^R	Bellows	Stainless Steel	AISI316L	SUS316L
⑦ ^R	Bellows Flange	Stainless Steel	A276-316L	—
⑧ ^R	Lower Bonnet Gasket	Graphite/Stainless Steel	—/AISI316	—/SUS316
⑨ ^R	Upper Bonnet Gasket	Graphite/Stainless Steel	—/AISI304	—/SUS304
⑩ ^R	Bonnet Bolt	Alloy Steel	A193 Gr.B7	—
⑪ ^R	Gland Packing	Graphite	—	—
⑫ ^R	Gland Bushing	Stainless Steel	A276-410	—
⑬ ^R	Gland Flange	Carbon Steel	A105	—
⑭ ^R	Gland Eye Bolt	Alloy Steel	A193 Gr.B7	—
⑮ ^R	Gland Nut	Carbon Steel	A94 Gr.2H	—
⑯ ^R	Handwheel	Ductile Cast Iron	A536	FCD450
⑰ ^R	Handwheel Nut	Carbon Steel	AISI1025	S25C
⑱	Nameplate	Stainless Steel	AISI304	SUS304
⑲ ^R	Screen	Stainless Steel	AISI430	SUS430
⑳ ^{MR}	Screen Holder Gasket	Stainless Steel	AISI316L	SUS316L
㉑	Screen Holder Plug	Stainless Steel	AISI303	SUS303
㉒	Blow-off Valve BO2	Stainless Steel	AISI420F	SUS420F
㉓ ^{MR}	Blow-off Valve Gasket	Stainless Steel	AISI316L	SUS316L

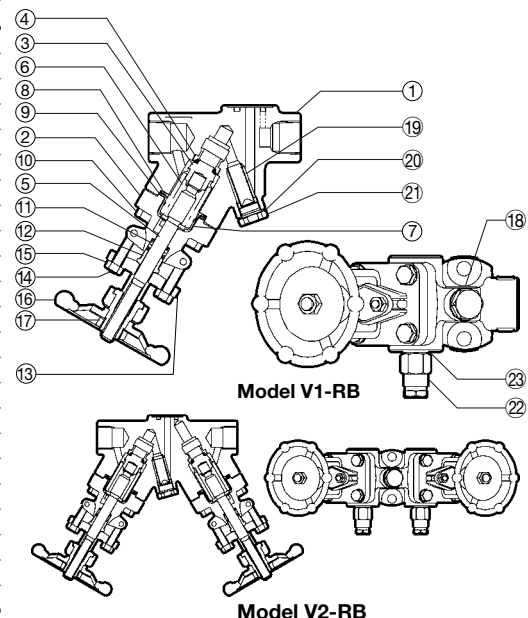

* Equivalent
Replacement kits available: (M) maintenance parts, (R) repair parts
Kits include parts for only one valve unit; V2 may require two kits.

Dimensions

● **V1-RB/V1-LB** Screwed & Socket Weld

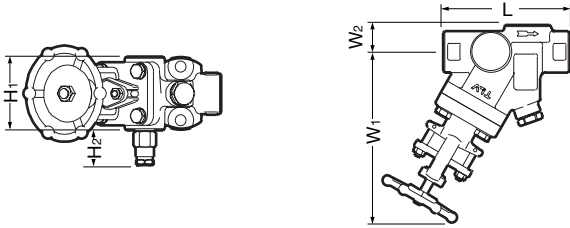

V1-RB shown; V1-LB is inverted (opposite flow direction)

● **V2-RB/V2-LB** Screwed & Socket Weld

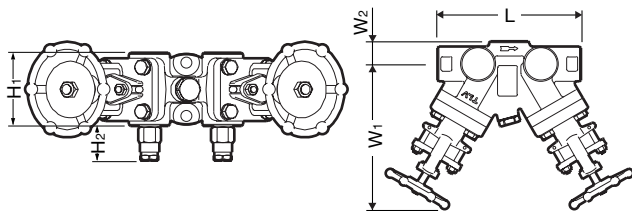

V2-RB shown; V2-LB is inverted (opposite flow direction)

● **Mounted Steam Trap Units (QuickTrap)**

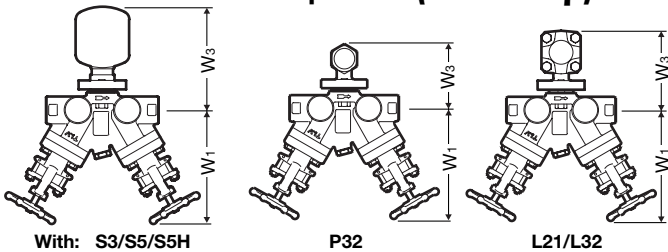

With: S3/S5/S5H

P32

L21/L32

V1-RB/V1-LB (in)

Size	L	H ₁	H ₂	W ₁ *	W ₂	Weight (lb)
1/2	4 3/4	2 3/4	1 5/16	7 1/16	1	7.5
3/4						

Screwed connections are NPT; other standards available
* At full-open position

V2-RB/V2-LB (in)

Size	L	H ₁	H ₂	W ₁ *	W ₂	Weight (lb)
1/2	6 5/16	2 3/4	1 5/16	7 1/16	1	13
3/4						

Screwed connections are NPT; other standards available
* At full-open position

● **Socket Weld Connections** (in)

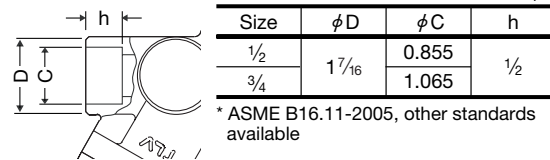

Model	W ₁ (in)	W ₃ (in)	Weight (lb)	
			With V1*	With V2*
S3	7 1/16	5 5/8	9.5	15
S5		6 7/8	10	16
S5H		7	9.0	14
P32		3 1/2	9.7	15
L21/L32		4 3/8		

* Combined weight of trap station with mounted trap unit

Valve Series

Model	V1-RB	V1-LB	V2-RB	V2-LB
Station Picture				
Flow Diagram				
Flow Direction	Right	Left	Right	Left
Inlet Valve	✓	✓	✓	✓
Outlet Valve	—	—	✓	✓
Trap Inlet Blowdown Valve	✓	✓	✓	✓
Trap Outlet Blowdown Valve	—	—	✓	✓
Available Trap Units*	Free Float	S3 / S5 / S5H		
	Thermodynamic	P32		
	Thermostatic	L21 / L32		

* For more information, see the **QuickTrap** specifications data sheet for the steam trap employing the desired trap unit (trap unit - **QuickTrap** data sheet): S3 - FS3/FS5; S5 - FS3/FS5; S5H - FS5H; L21 - FL21/FL32; L32 - FL21/FL32

** Capacities shown here will vary depending on orifice numbers, type of X-element and/or pressure differential.

● **Steam Trap Unit Specifications***

Free Float Steam Trap S3 / S5 / S5H	
PMO: 300 / 450 / 650 psig	
TMO: 752 / 752 / 800 °F	
Max. Discharge Capacity** 475 / 1510 / 530 lb/h	
Thermodynamic Steam Trap P32	
PMO: 450 psig	
TMO: 750 °F	
Max. Discharge Capacity** 1180 lb/h	
Thermostatic Steam Trap L21 / L32	
PMO: 300 / 450 psig	
TMO: 455 / 464 °F	
Max. Discharge Capacity** 1050 / 930 lb/h	

TLV CORPORATION

13901 South Lakes Drive, Charlotte, NC 28273-6790
Phone: 704-597-9070 Fax: 704-583-1610
E-mail: tlv@tlvengineering.com
For Technical Service 1-800 "TLV TRAP"



Manufacturer
TLV CO., LTD.
Kakogawa, Japan
is approved by LRQA Ltd. to ISO 9001/14001

ISO 9001/ISO 14001

